

JBC

www.jbctools.com



Desoldering Iron

Ref. DR560

Packing List

DR560-A
Desoldering Iron



MANUAL



C560013



C560004



C560005



0812360
Internal
Joint Case



0780840
Filter



0965760
Long cleaning
tips set



0786640 Cleaning stick



0965970
Cleaning tips set



0780550
Spanner



0812630 Metal tin diposit



0812620 Tin diposit



Features

MS-A
Desoldering Pump

Control Unit

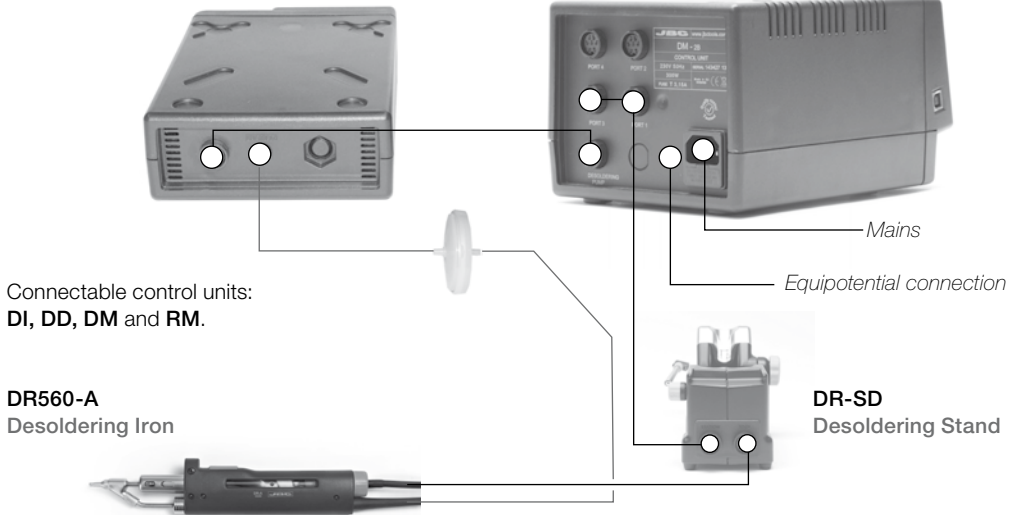

Desoldering process

Use the tip model with a larger diameter than the pad to be desoldered, so as to achieve maximum aspiration and thermal efficiency.

1. Apply the desoldering iron tip so that the component terminal penetrates within its orifice.
2. When the solder liquefies, start gently to rotate the desoldering tip so that the component's terminal can be eased away from the sides.
3. Press then, not before, the vacuum pump push-button just long enough to aspirate the solder.

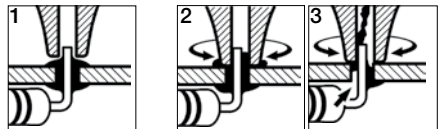

After pressing the desoldering key there is a slight delay until the self-contained vacuum pump stops, this is to make sure that the vacuum circuit is completely empty.

If any solder remains are left on any terminal after attempting to desolder it, resolder it with fresh solder and repeat the desoldering operation.

Changing Tips

This operation should be done while the tip is hot, at a minimum temperature of 250°C, so that any tin left inside is in molten state.

- Unscrew the tip to be replaced, with the aid of the spanner supplied.
- Fit the new tip, and tighten up with the spanner to achieve a good air tightness.



Compatible Tips

The DR560 works with C560 tips. Find the model that best suits your soldering needs in www.jbctools.com

See here some of them in real size:

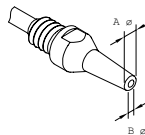

C560-001 $\varnothing A=1,4$ $\varnothing B=0,6$ $\varnothing \text{max. pin}=0,4$

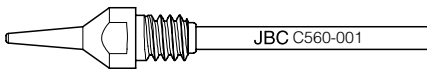

C560-002 $\varnothing A=1,8$ $\varnothing B=0,8$ $\varnothing \text{max. pin}=0,6$

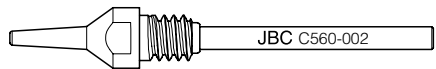

C560-014 $\varnothing A=2,5$ $\varnothing B=0,8$ $\varnothing \text{max. pin}=0,6$

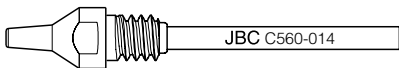

C560-003 $\varnothing A=2,7$ $\varnothing B=1$ $\varnothing \text{max. pin}=0,8$

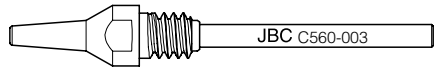

C560-004 $\varnothing A=3,2$ $\varnothing B=1,3$ $\varnothing \text{max. pin}=1,1$

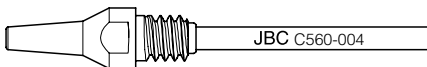

C560-009 $\varnothing A=5$ $\varnothing B=1,3$ $\varnothing \text{max. pin}=1,1$

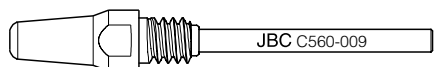

Changing the Heating Element

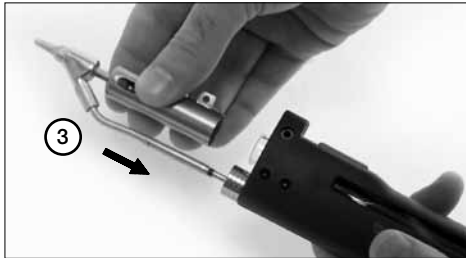

1. To perform this operation, shut down the station or disconnect the tool, the deposit lid needs to be loosened.
2. Undo the screw indicated in the picture and remove the heating element.
3. Place the new heating element.

Important.

- For a good connection it is essential to insert the cartridge lining up the mark ▶|.
- Tighten the screw indicated in the picture 2 and then tighten the lid 1.

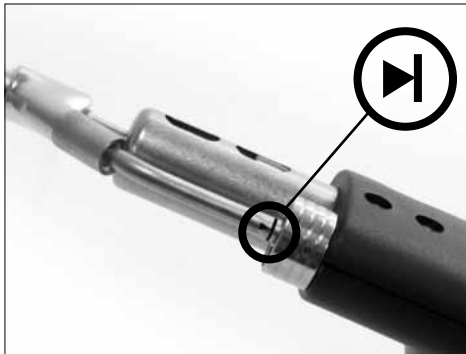

Maintenance

Before carrying out maintenance or storage, always unplug the tool.

- Check periodically that the metal parts are clean to ensure a good detection when it is in the stand. Use a damp cloth or alcohol.
- Periodically check all cables and tubes connections.
- Replace any defective or damaged pieces. Use original JBC spare parts only.
- Repairs should only be performed by a JBC authorized technical service.

Tin Deposit Maintenance



For this, the lid needs to be unscrewed with the DR560 in vertical position.

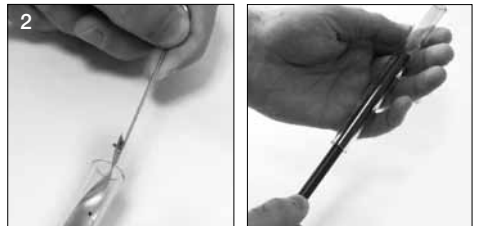

Then its spiral must be removed to clean the inner part of the deposit with the provided stick.

- The condition of the filter and internal joint must be checked and replaced if dirty or damaged.



The deposit needs to be inserted with spiral filter put into place, positioned between the 2 lines marked on the tin deposit. Then the whole must be closed by screwing the lid 1.

Tip Care

- The largest rod that fits in the tip hole should periodically be passed through in order to clean the intake tube. You can use any one supplied with the CL9885 Tip Cleaning Stand.

- **Important:** DO NOT press the pushbutton vacuum pump while tinning the desoldering tip, as the fumes given off by the flux would quickly soil the ducts and filter of the air circuit.

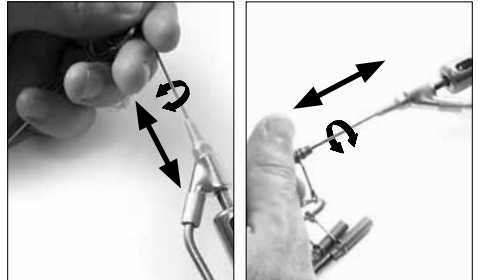

Safety



It is imperative to follow safety guidelines to protect health and prevent electric shock, injury, fire or explosions.

- Do not use the kit for any purpose other than soldering or rework. Incorrect use may cause fire.
- The temperature of accessible surfaces may remain high after the unit is turned off. Handle with care.
- Do not leave the appliance unattended when it is on.
- It is necessary to turn the station off before changing cartridges. The screw ensures the appropriate operation of the tool.
- Heat can cause inflammable products to ignite even when out of sight.
- Be careful with the remains of liquid tin. In contact with skin, it can cause burns.
- Use a “non residue” classified flux and avoid contact with skin or eyes to prevent irritation.
- Be careful with the fumes produced when soldering.
- Keep your workplace clean and tidy. Wear appropriate protection glasses and gloves when working to avoid personal harm.
- This appliance can be used by children over the age of eight and persons with reduced physical, sensory or mental capabilities or lack of experience and knowledge once they have been given adequate supervision or instruction concerning use of the appliance and understand the hazards involved. Children must not play with the appliance. Maintenance shall not be carried out by children unless supervised.

JBC

Warranty

JBC's 2 year warranty covers this equipment against all manufacturing defects, including the replacement of defective parts and labour.

Warranty does not cover product wear due to use or mis-use.

In order for the warranty to be valid, equipment must be returned, postage paid, to the dealer where it was purchased.



This product should not be thrown in the garbage.

In accordance with the European directive 2002/96/EC, electronic equipment at the end of their life must be collected and returned to an authorized recycling facility.